

JEA48 SERIES

CONTACT CONFIGURATION: SPST, N.O.

MAIN CONTACT DATA

I THERMAL, Ith: 600 AMPS
 RESISTIVE LOAD: 600 AMPS @ 60 VDC MAX
 OVERLOAD: 900 AMPS PER UL 508
 CONTACT VOLTAGE DROP: <40 mV TYPICAL
 MATERIAL: AgSnO2

COIL DATA

COIL VOLTAGES: 12 - 340 VDC
 COIL TYPES:
 CONTINUOUS DUTY
 INTERMITTENT DUTY
 PROLONGED DUTY
 HIGH POWER INTERMITTENT DUTY

OPTIONS

- AUXILIARY CONTACTS
- 5 AMPS, 250VAC
- FORM C SPDT
- MOUNTING BRACKETS
- SERATED CONTACTS
- COIL SUPPRESSION
- FLYING LEADS
- ACV COIL W/ RECTIFIER

TEMPERATURE: -20°C TO +50°C
 MECHANICAL LIFE: >3 X 10⁶
 IP CODE: IP31 PER IEC 60529
 APPROXIMATE WEIGHT: 0.9 kg [2.0 lbs]
 RoHS COMPLIANT
 TELECOM UL FILE: E161810
 RECOMMENDED TORQUE, MS: 15 In-Lb [1.7 Nm] MAX.

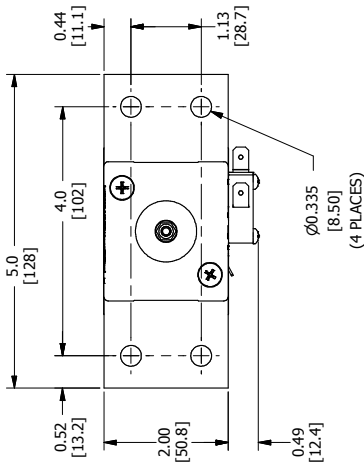

SINGLE POLE SINGLE THROW
 NORMALLY OPEN

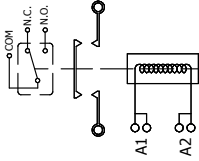

SINGLE POLE SINGLE THROW
 NORMALLY OPEN

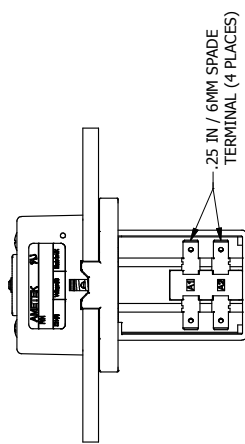
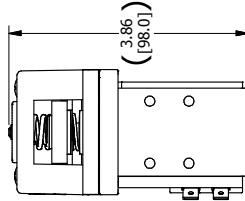
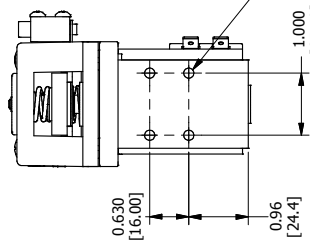
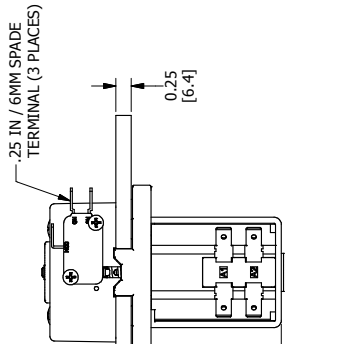
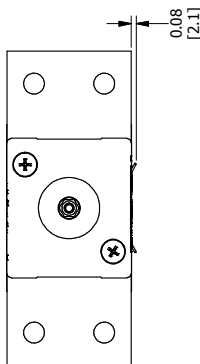
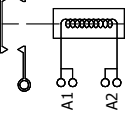

| CHANGE RECORD | | UNLESS OTHERWISE SPECIFIED: | | FINISH CODE PER | | MATERIAL | | REWORK | |
|---------------|----|-----------------------------|--------|-----------------|-------------|----------|------|-------------|--------|
| DATE | BY | DESCRIPTION | REASON | CODE | DESCRIPTION | REASON | CODE | DESCRIPTION | REASON |
| | | | | | | | | | |

| MATERIAL | | MATERIAL | | MATERIAL | | MATERIAL | |
|----------|-------------|----------|-------------|----------|-------------|----------|-------------|
| ITEM # | DESCRIPTION | ITEM # | DESCRIPTION | ITEM # | DESCRIPTION | ITEM # | DESCRIPTION |
| | | | | | | | |

| CONTACT, SPST, N.O. | |
|---------------------|----|
| DATE | BY |
| 09-08-10 | |

| DRAWING | |
|---------|----------|
| NO. | DATE |
| 1 | 09-08-10 |
| 2 | |

| DRAWING | |
|---------|----------|
| NO. | DATE |
| 1 | 09-08-10 |
| 2 | |

| DRAWING | |
|---------|----------|
| NO. | DATE |
| 1 | 09-08-10 |
| 2 | |

| DRAWING | |
|---------|----------|
| NO. | DATE |
| 1 | 09-08-10 |
| 2 | |

| DRAWING | |
|---------|----------|
| NO. | DATE |
| 1 | 09-08-10 |
| 2 | |

UNLESS OTHERWISE SPECIFIED:
 THE DRAWING IS BEING VIEWED FROM THE
 FRONT VIEW.
 DIMENSIONS ARE IN MILLIMETERS UNLESS
 OTHERWISE NOTED.
 ALL DIMENSIONS ARE TO CENTER UNLESS
 OTHERWISE NOTED.
 ALL DIMENSIONS ARE TO CENTER UNLESS
 OTHERWISE NOTED.
 ALL DIMENSIONS ARE TO CENTER UNLESS
 OTHERWISE NOTED.



JEA48 SERIES